

The water service work for the A1 Tower will begin on 2/5/18 and go until 2/14/18. This work will be done during the day and NO PARKING SIGNS will be posted on both the North and South sides of street.

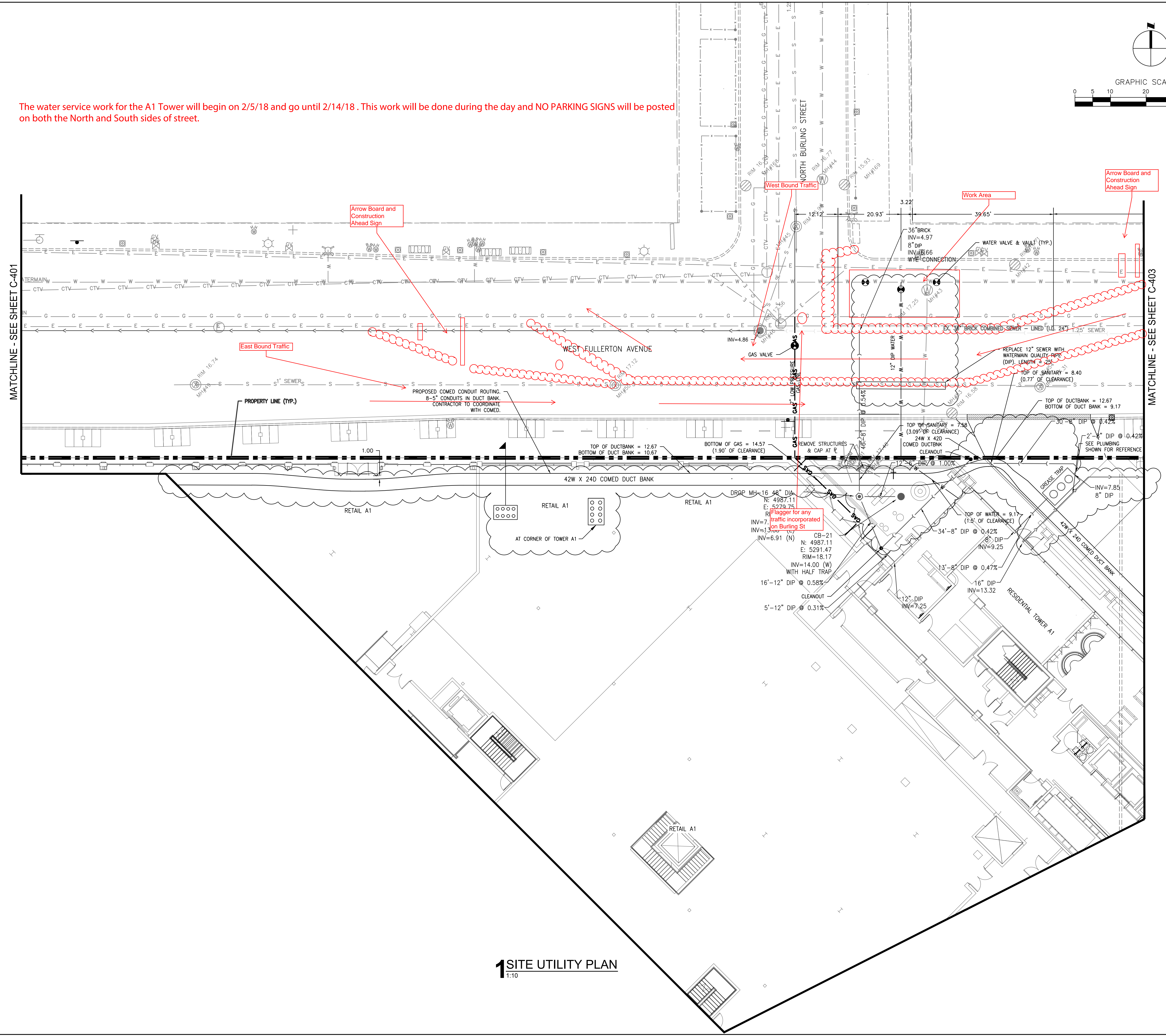
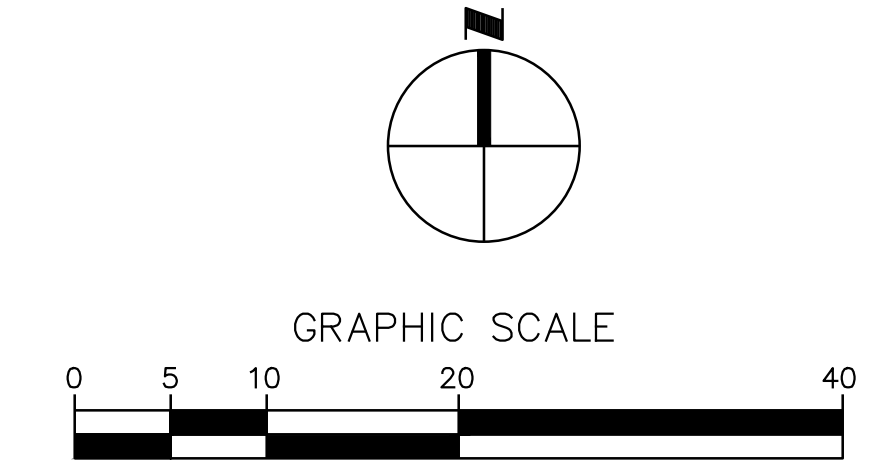

MATCHLINE - SEE SHEET C-401

MATCHLINE - SEE SHEET C-403

1 SITE UTILITY PLAN
1:10

THE LINCOLN COMMON
Chicago, Illinois 60604
Building A1: 2345 N. Lincoln Ave.
Building A2: 2335 N. Lincoln Ave.
Building C: 2380 N. Lincoln Ave.
Building D: 2350 N. Lincoln Ave.
Building E: 2316 N. Lincoln Ave.

CLIENT: **Hines McCaffery**

ARCHITECT: **SOM**
Skidmore, Owings & Merrill LLP
224 South Michigan Avenue, Suite 1000, Chicago, IL 60604

ARCHITECT: **ANTUNOVICH ASSOCIATES**
ARCHITECTURE - PLANNING - INTERIOR DESIGN
224 W Huron Street, Chicago IL 60654

STRUCTURAL ENGINEER: **HALVORSON AND PARTNERS**
A WSP | PARSONS BRINCKERHOFF COMPANY
600 W Chicago Ave, Suite 650, Chicago, IL 60654

MEP ENGINEER: **Cosentini**
a Tetra Tech Company
1 South Wacker Dr, 37th Floor, Chicago, IL 60606

DESIGN TEAM AND CONSULTANTS:
EPSTEIN
WOLFF LANDSCAPE ARCHITECTURE, INC.
GEI CONSULTANTS, INC.
HWA PARKING
PERSHON HAHN ASSOCIATES INC.
SHINER ASSOCIATES, INC.
HMA CONSULTING
ARCHILUCE INTERNATIONAL
DIG STUDIOS
BEASLEY & HENLEY INTERIOR DESIGN
INNOVATIVE AQUATIC DESIGN

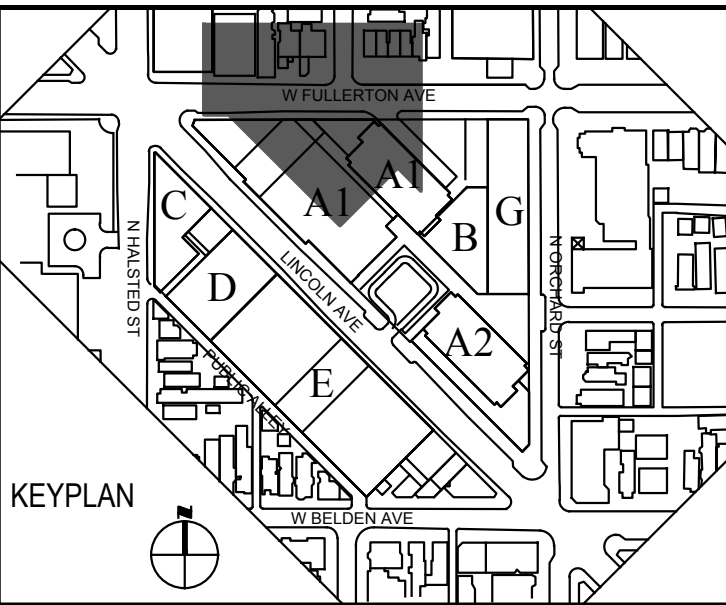
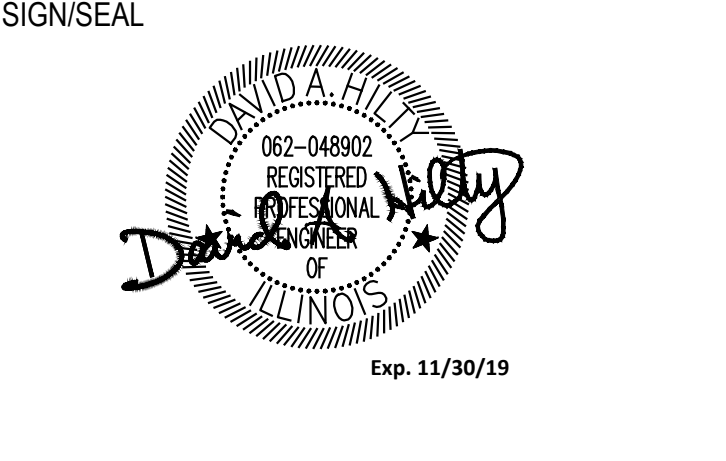

GENERAL NOTES

#	DATE	ISSUE DESCRIPTION
10	11/03/2017	CDI #7
9	10/29/2017	ISSUED FOR OUC
8	08/04/2017	CDI #5
7	06/28/2017	CDI #3
6	05/22/2017	PERMIT REV - FOUNDATION & SUPERSTRUCTURE
5	04/24/2017	PERMIT REV 2 - FOUNDATION & SUPERSTRUCTURE
4	02/24/2017	ISSUED FOR OUC
3	02/24/2017	PERMIT - FOUNDATION & SUPERSTRUCTURE
2	02/03/2017	CDI #1
1	01/15/2017	IN PROGRESS FOUNDATION & SUPERSTRUCTURE

SITE UTILITY PLAN

PROJECT NO. 212131
DATE: 27 JUL 2017
SCALE: 1:10
SHEET NO. **C-402**

C-402

© Copyright Skidmore, Owings & Merrill LLP